

NORTH

# Long Range Vision: The Problem

- Move laws + create interesting public realm
- Build connections across for pedestrians
- Add civic street greening
- Mitigate noise
- Make user friendly access from the "Suburbs"

## - Infrastructure Act

### ISSUES

- BALANCE OF MODES
  - too much pavement? - lane width?
- MORE GREEN SPACE
- MORE LAND USE
- REDUCE DIVISIONS
  - PEDESTRIAN ENVR.

### PEDESTRIAN ENR

#### • CONNECTIONS

LORING PARK → WALKER  
→ SCULP GARDEN

LYN → DT  
HEN → DT

SHAPE PARK → SAFETY  
SPEND MONEY ON PED REALM — NOT PARKING LOTS

#### • AESTHETICS

#### • SUSTAINABILITY

#### • NEW LAND USE

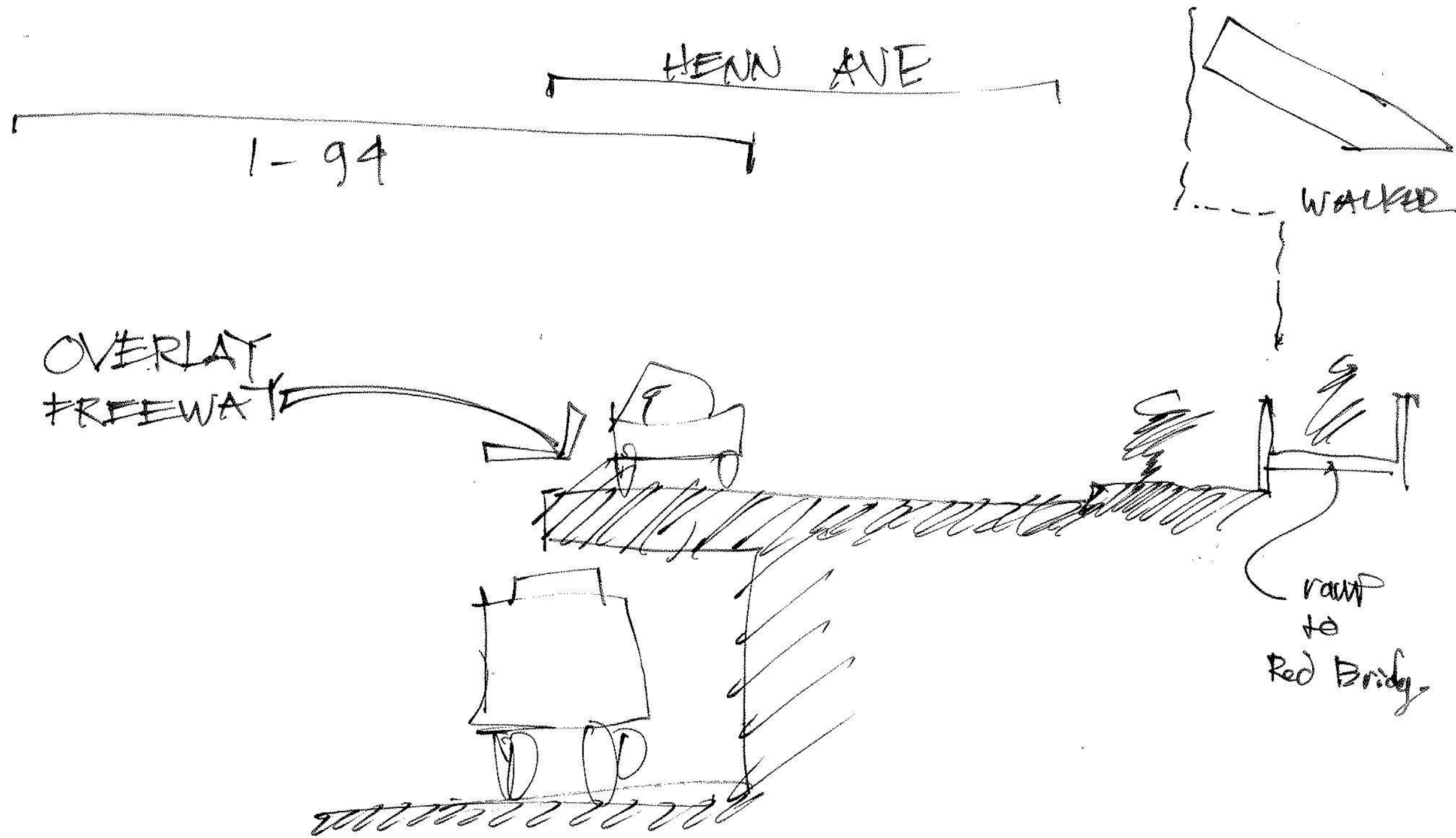

SECTION - looking south



April 26, 2008

Lowry Hill Residents, Inc. (LHRI)  
Citizens for a Loring Park Community (CLPC)  
AIA Minneapolis

Hennepin & Lyndale Area Re-Design Charrette  
Minneapolis, Minnesota

Charrette Diagrams

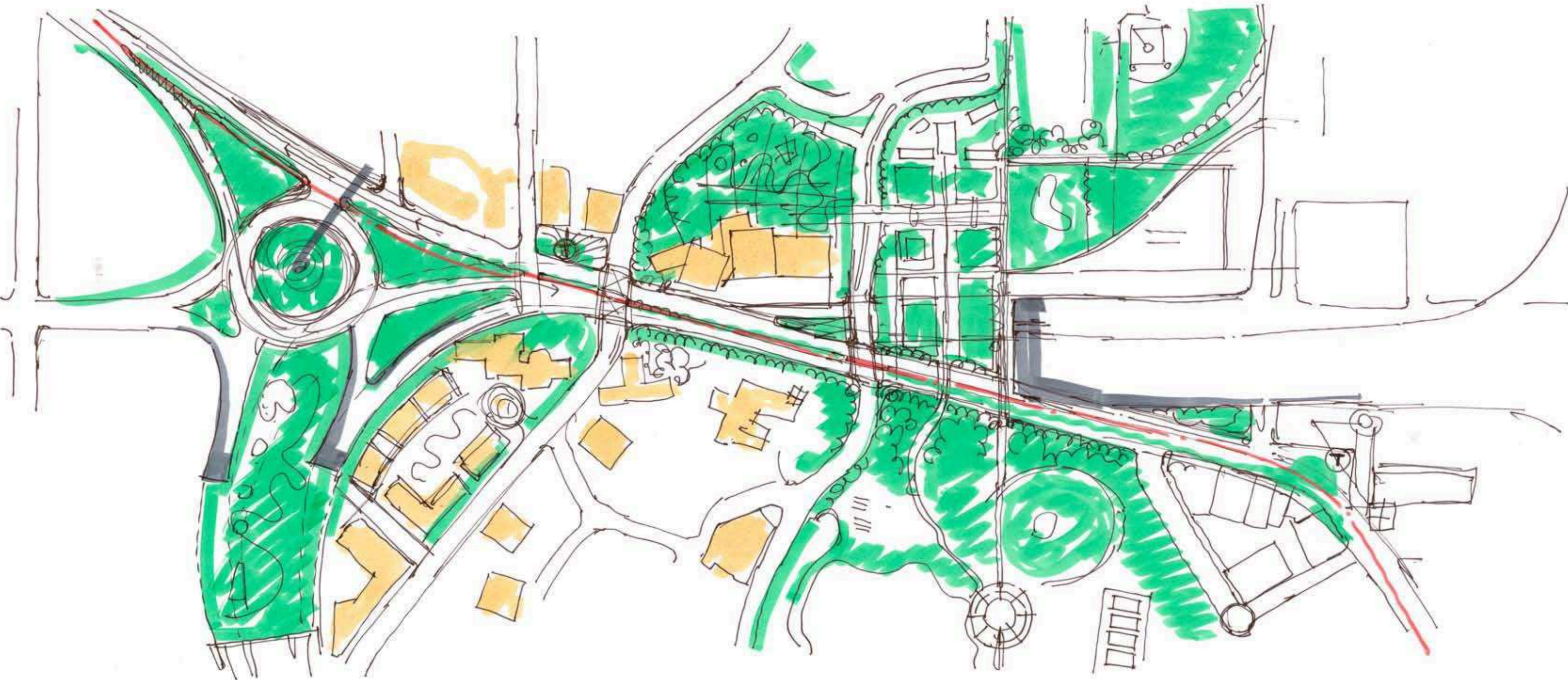

April 26, 2008

Lowry Hill Residents, Inc. (LHRI)  
Citizens for a Loring Park Community (CLPC)  
AIA Minneapolis

Hennepin & Lyndale Area Re-Design Charrette  
Minneapolis, Minnesota

Charrette Diagrams

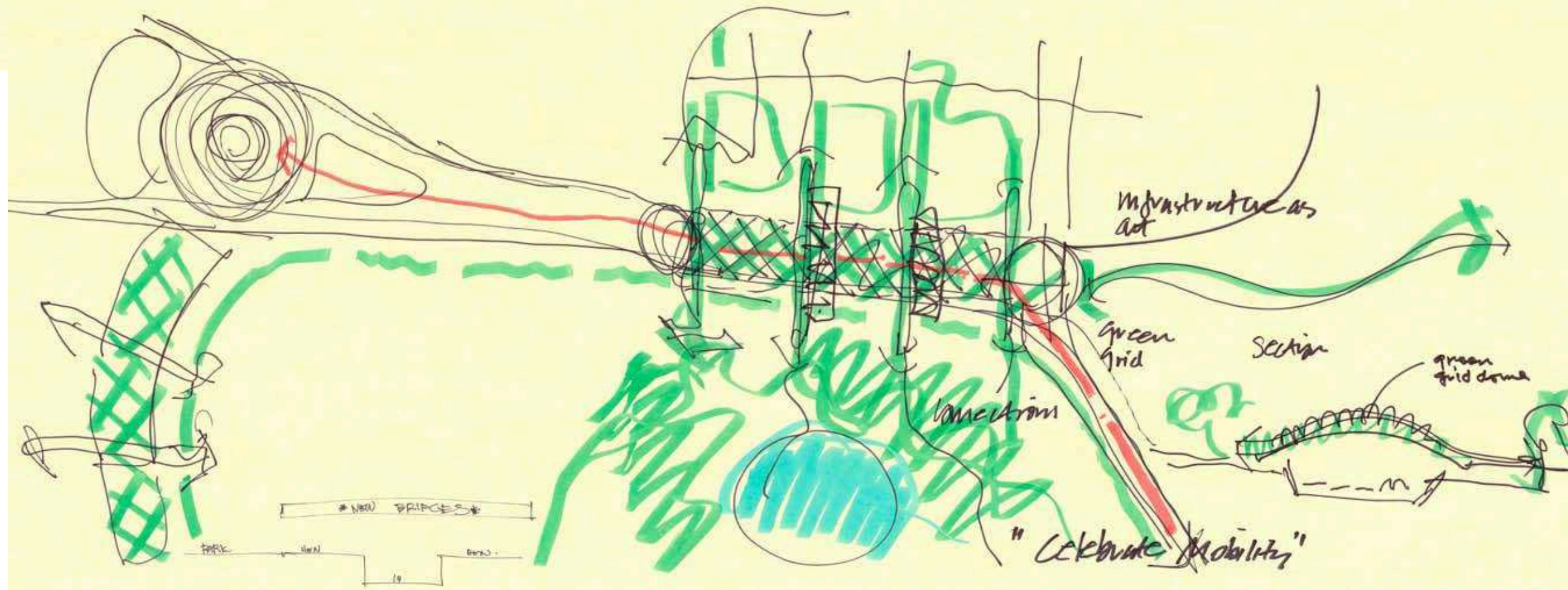
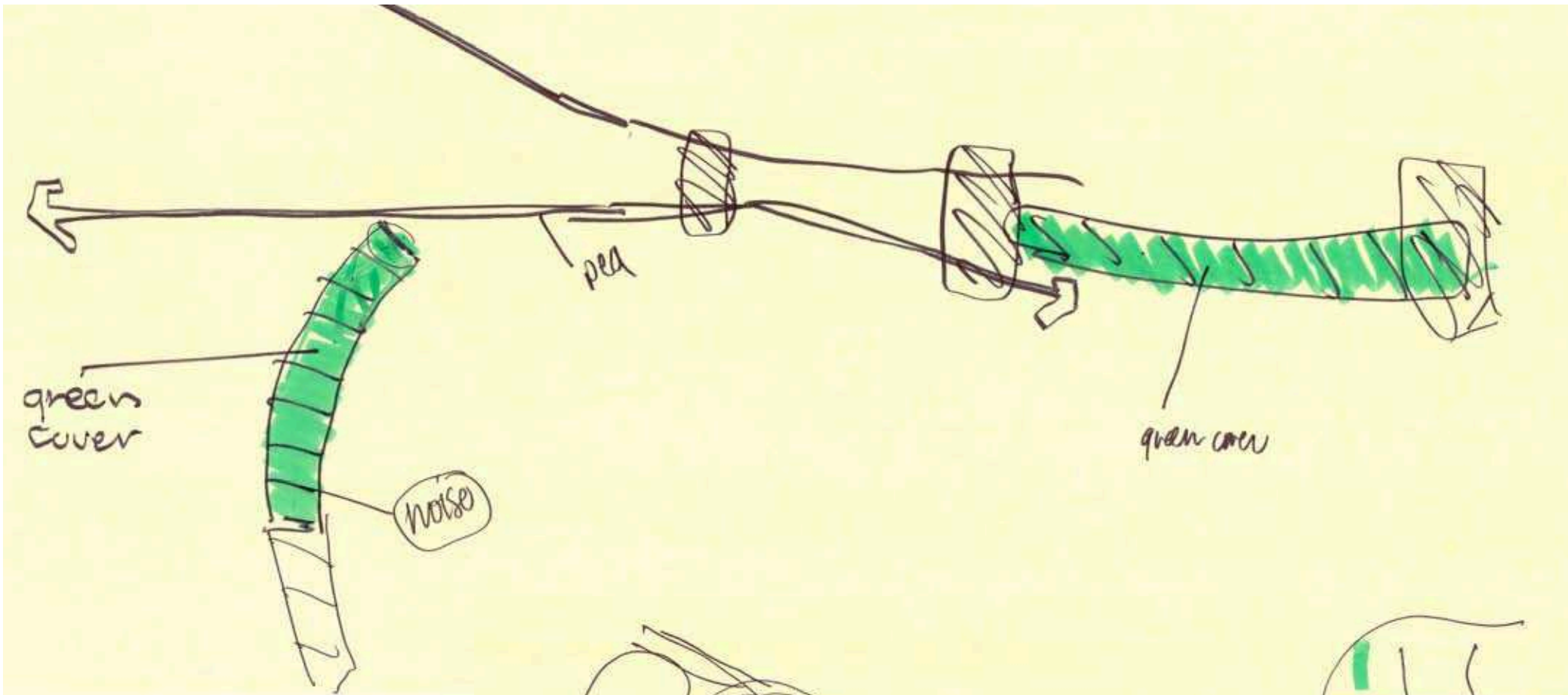

April 26, 2008

Lowry Hill Residents, Inc. (LHRI)  
 Citizens for a Loring Park Community (CLPC)  
 AIA Minneapolis

Hennepin & Lyndale Area Re-Design Charrette  
 Minneapolis, Minnesota

Charrette Diagrams

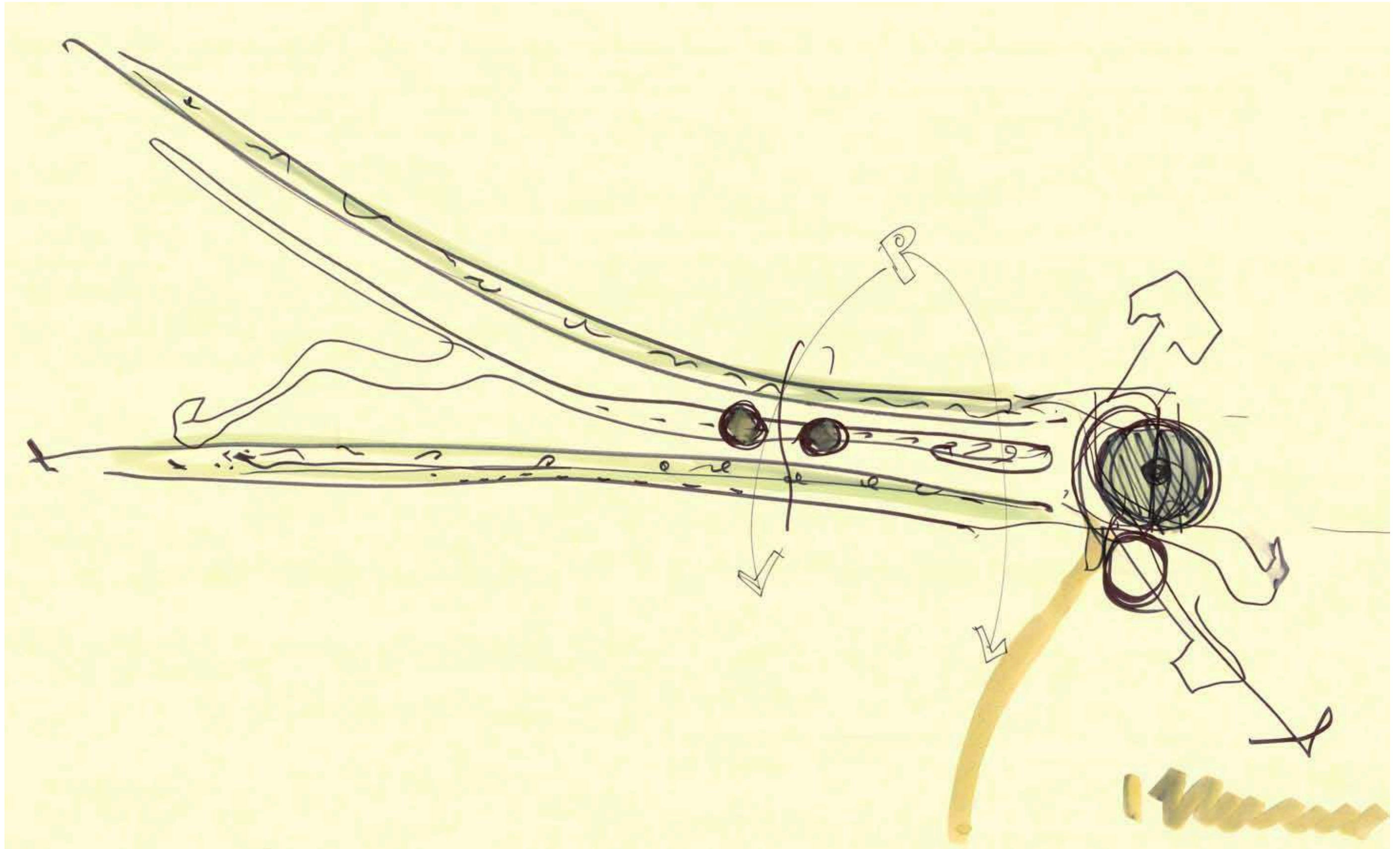

April 26, 2008

Lowry Hill Residents, Inc. (LHRI)  
Citizens for a Loring Park Community (CLPC)  
AIA Minneapolis

Hennepin & Lyndale Area Re-Design Charrette  
Minneapolis, Minnesota

Charrette Diagrams

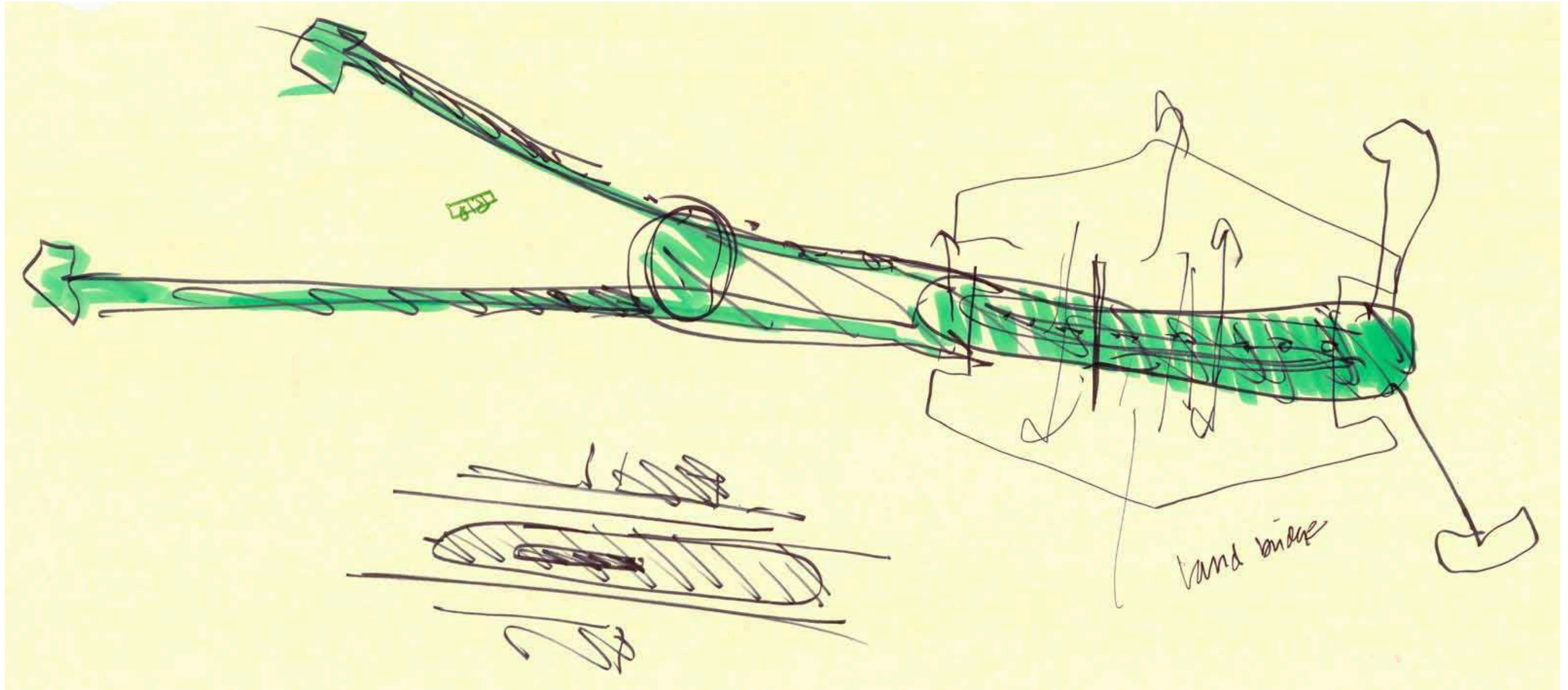

April 26, 2008

Lowry Hill Residents, Inc. (LHRI)  
Citizens for a Loring Park Community (CLPC)  
AIA Minneapolis

Hennepin & Lyndale Area Re-Design Charrette  
Minneapolis, Minnesota

Charrette Diagrams

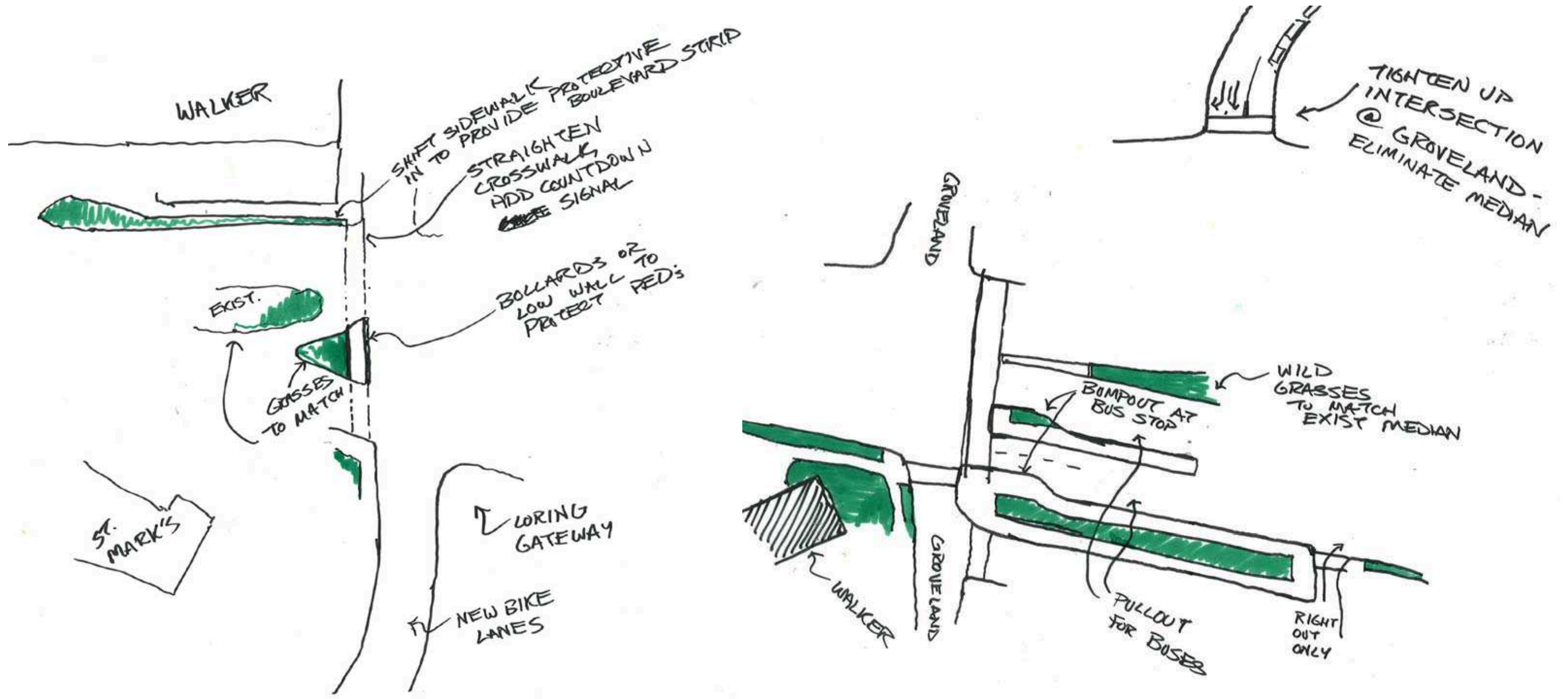

April 26, 2008

Lowry Hill Residents, Inc. (LHRI)  
 Citizens for a Loring Park Community (CLPC)  
 AIA Minneapolis

Hennepin & Lyndale Area Re-Design Charrette  
 Minneapolis, Minnesota

Charrette Diagrams

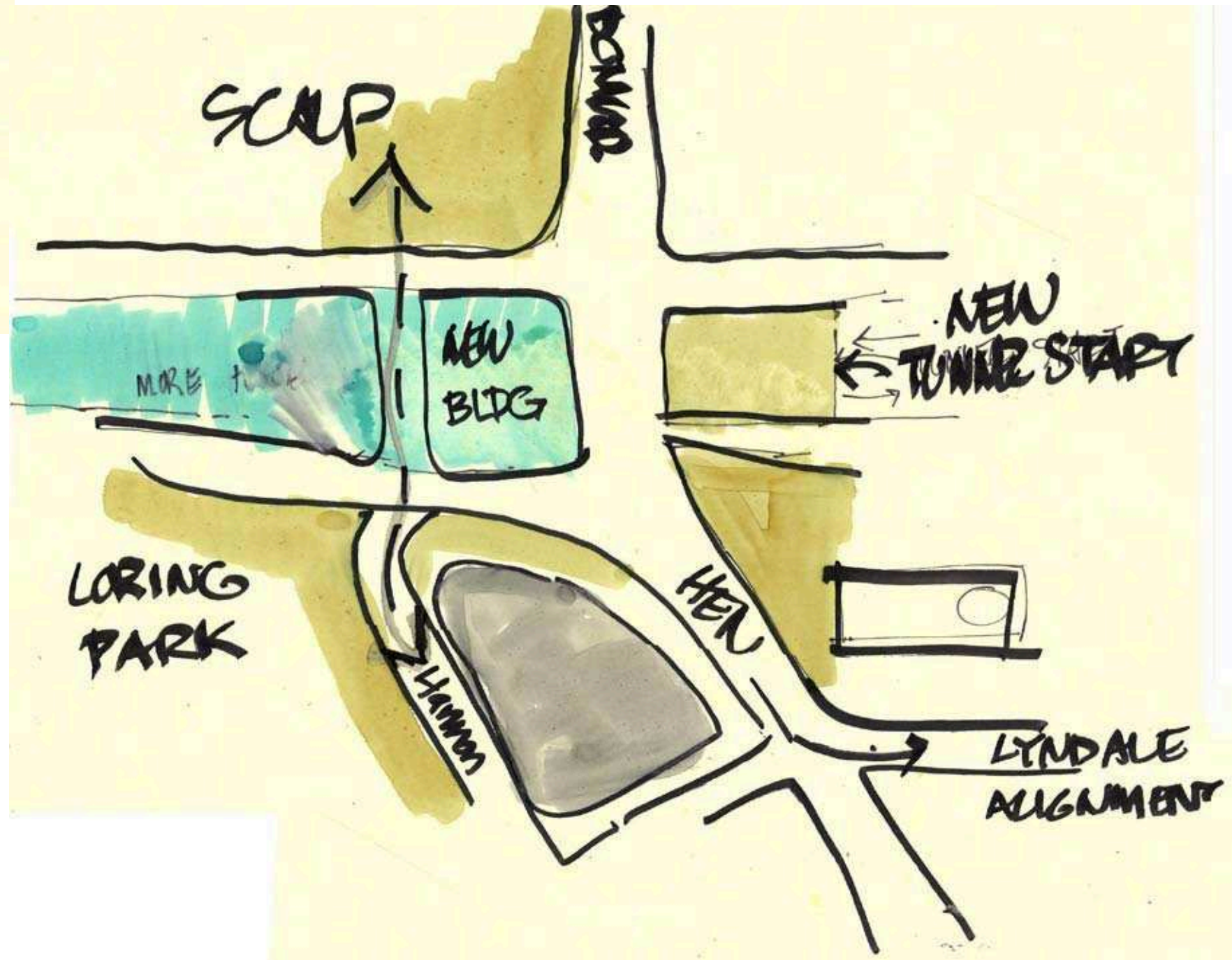
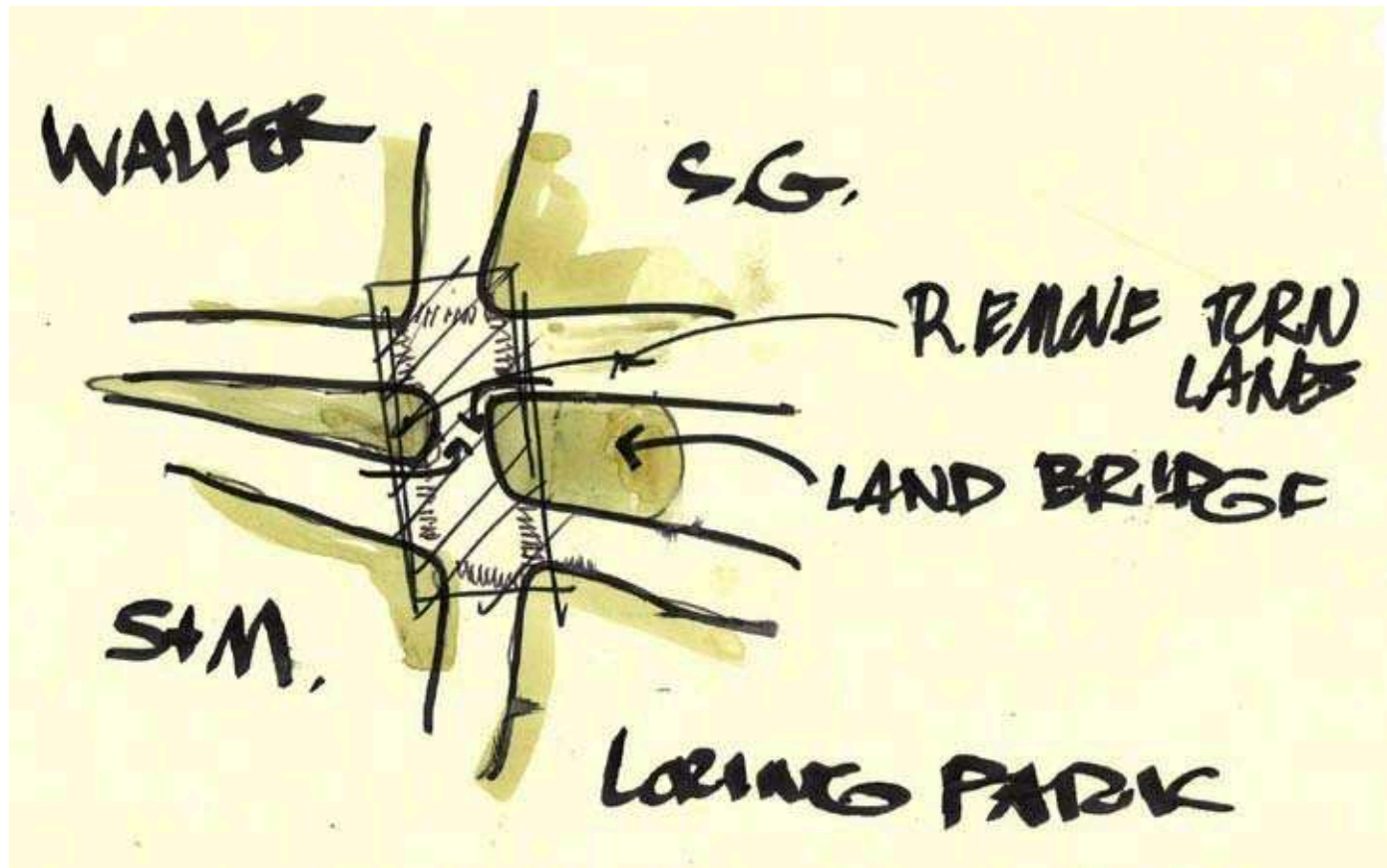

April 26, 2008

Lowry Hill Residents, Inc. (LHRI)  
 Citizens for a Loring Park Community (CLPC)  
 AIA Minneapolis

Hennepin & Lyndale Area Re-Design Charrette  
 Minneapolis, Minnesota

Charrette Diagrams

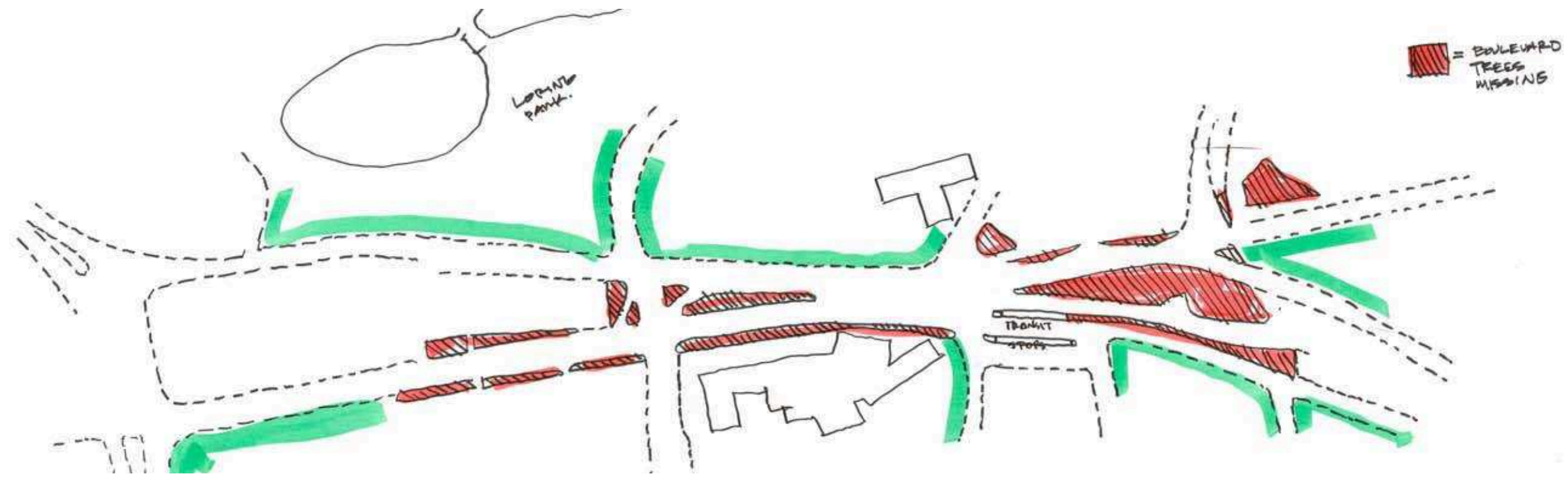
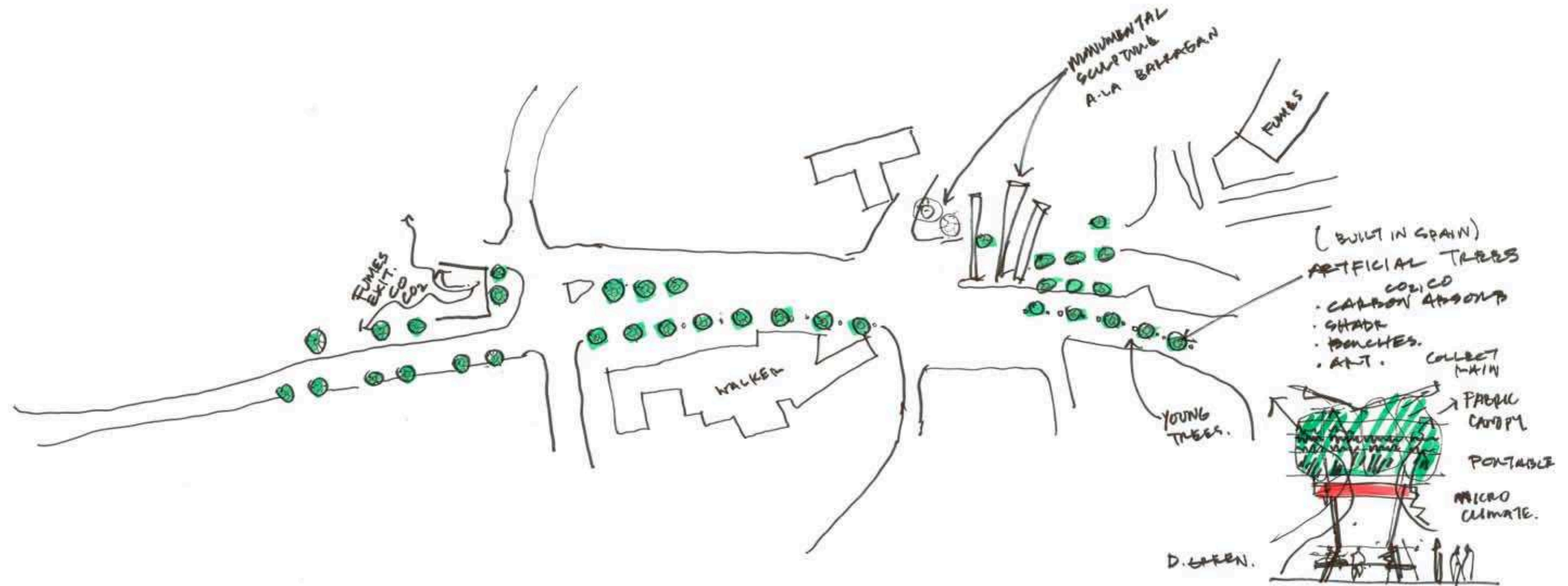

April 26, 2008

Lowry Hill Residents, Inc. (LHRI)  
Citizens for a Loring Park Community (CLPC)  
AIA Minneapolis

Hennepin & Lyndale Area Re-Design Charrette  
Minneapolis, Minnesota

Charrette Diagrams

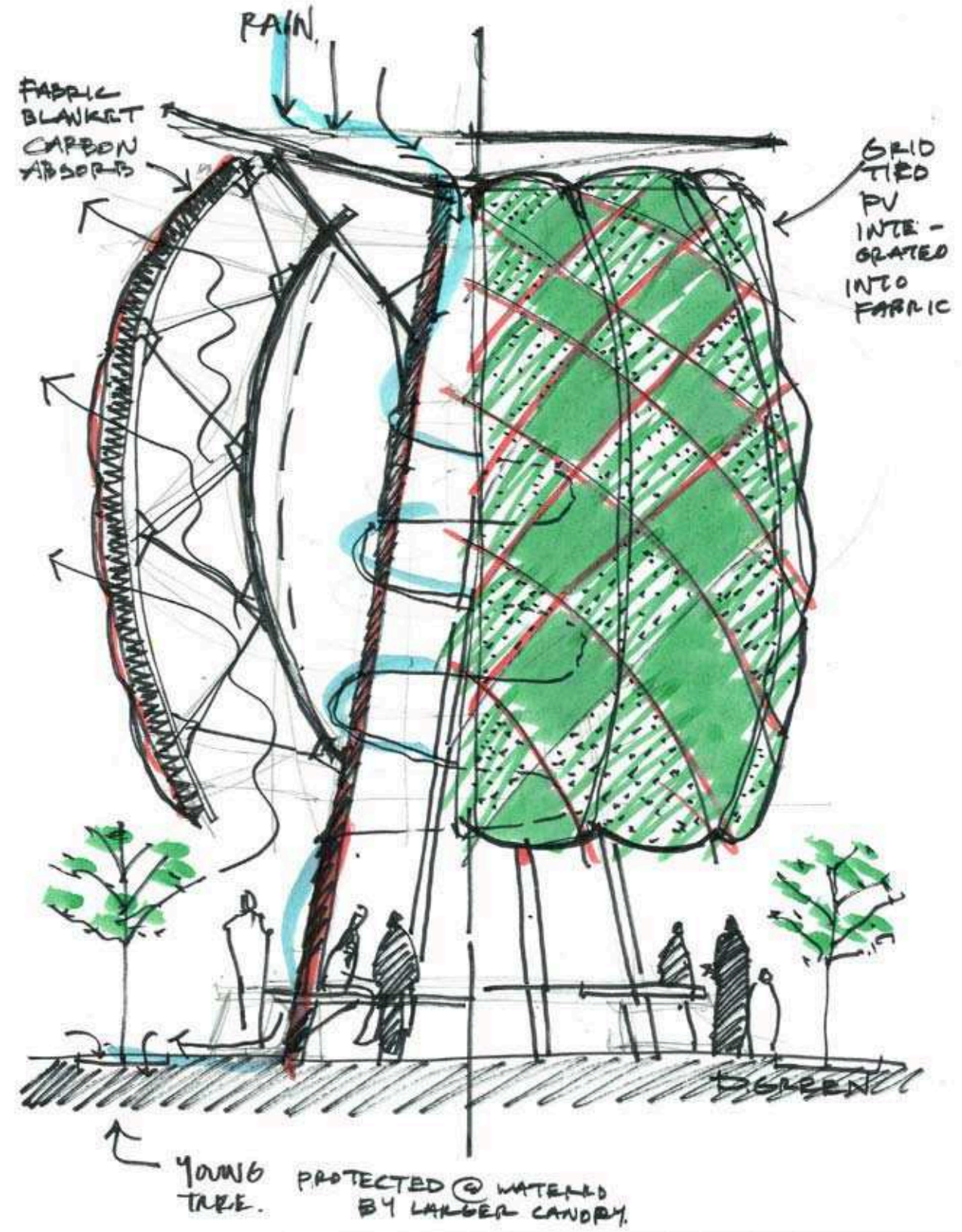
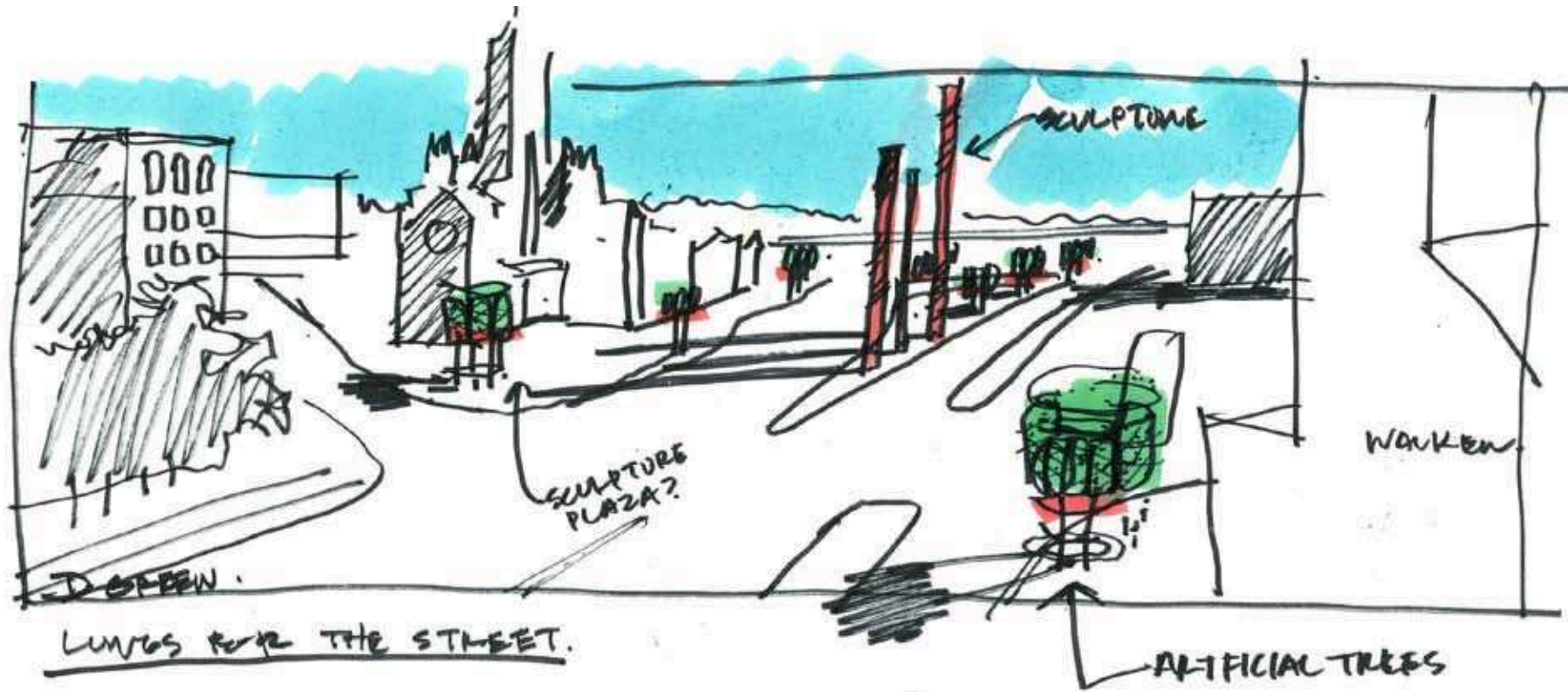

April 26, 2008

Lowry Hill Residents, Inc. (LHRI)  
 Citizens for a Loring Park Community (CLPC)  
 AIA Minneapolis

Hennepin & Lyndale Area Re-Design Charrette  
 Minneapolis, Minnesota

Charrette Diagrams